

BOSE[®]



BOSE[®] MIE2i MOBILE HEADSET

Owner's Guide | Brugervejledning | Bedienungsanleitung
Guía de usuario | Notice d'utilisation | Manuale di istruzioni
Gebruiksaanwijzing | Bruksanvisningen
Podręcznik użytkownika | Felhasználói útmutató
Omistajan opas | คู่มือผู้ใช้ | 사용자 안내서 | 用戶指南
使用者指南 | オーナースガイド | دليل المالك

Welcome

Thank you for purchasing the Bose® MIE2i mobile headset for select Apple products. The Bose® MIE2i mobile headset offers a combination of lifelike audio performance and comfortable fit not available from most conventional headsets.

For use with:

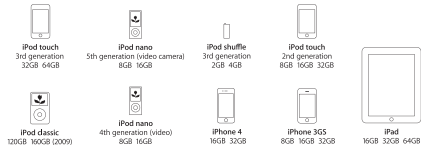

Compatible with MacBook and MacBook Pro computers.

Register your product

Now is a good time to register your headset. You can do this easily by going to <http://global.Bose.com/register>.

CE This product conforms to all EU Directive requirements as applicable by law. The complete Declaration of Conformity can be found at www.Bose.com/compliance.

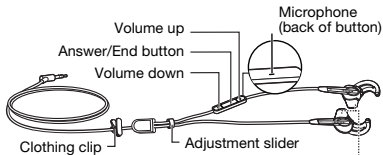

Carrying case

StayHear™ tips

Large
(black)



left right

Medium
(grey)



left right

Small
(white)



left right

**Headset comes with medium StayHear™ tips attached.*

Connecting to your Apple device

You can connect the headset to the standard 3.5 mm headphone jack on your iPhone, iPod, or other Apple product.

Using the headset with your Apple device

The Bose® MIE2i mobile headset includes a small in-line remote with an integrated microphone. This offers an easy to access Answer/End and volume control buttons.

Note: Full controls may not be available for some Apple products.

The remote and mic are supported only by iPod nano (4th and 5th generation), iPod classic (120GB, 160GB only), iPod touch (2nd and 3rd generation), iPhone 3GS, iPhone 4, and iPad. The remote is supported by iPod shuffle (3rd generation). Audio is supported by all iPod models. Requires latest iPod software.

Headset controls

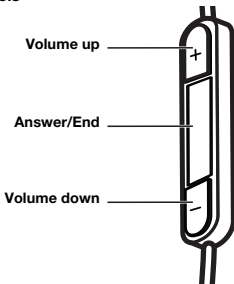

Basic functions

| | |
|-----------------|---------------------------------|
| Increase volume | Press and release the + button. |
| Decrease volume | Press and release the - button. |

Call-related functions

| | |
|--|--|
| Answer a call | When you receive an incoming call, press and release the Answer/End button to answer |
| End a call | Press and release the Answer/End button. |
| Decline an incoming call | Press and hold the Answer/End button for about two seconds, then release. |
| Switch to an incoming or on-hold call and put the current call on hold | While on a call, press and release the Answer/End button once. Press and release again to switch back to the first call. |
| Switch to an incoming or on-hold call and end the current call | While on a call, press and hold the Answer/End button for about two seconds, then release. |
| Use Voice Control | Press and hold the Answer/End button. <i>See iPhone User Guide for compatibility and usage information about this feature.</i> |

Media playback functions

| | |
|------------------------------------|--|
| Play or pause a song or video | Press and release the Answer/End button. |
| Skip to the next song or chapter | Press and release the Answer/End button twice quickly. |
| Fast-forward | Press and release the Answer/End button twice quickly and hold the second press. |
| Go to the previous song or chapter | Press and release the Answer/End button three times quickly. |
| Rewind | Press and release the Answer/End button three times quickly and hold the third press. |

Importance of Proper Fit

When you wear the headset properly, it provides the comfort and clarity you expect from Bose®.

Fitting the headphones to your ear

The headphone earpiece has a soft StayHear™ tip attached, allowing it to rest comfortably in the bowl of your ear. The wing part of the tip fits just under your ear ridge.

Note: Each tip is marked with either an L or an R to indicate which earpiece it is for. Be sure to attach the left StayHear™ tip to the left earpiece and the right StayHear™ tip to the right earpiece.



To determine if the tip is the right size:

1. Insert the earpiece into the canal just enough for the headphone to rest lightly against your ear.
2. Tilt the headphone back and press the tip wing under the ear ridge until it is secure.

The tips should fit comfortably yet securely in the bowl of the ear.

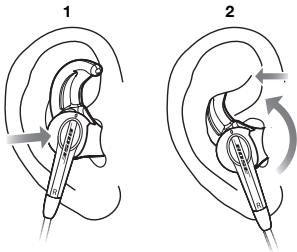

Changing ear tips

Select the type and size of eartip that provides you with the best comfort and fit.

1. Gently peel the edges of the attached tip away from the earpiece, using care not to tear the tip.

CAUTION: To prevent damage, do not pull on the StayHear™ tip wing.

2. Position the opening of the new tip over the nozzle and the small slot over the nozzle hook.

Note: Each tip is marked with either an L or an R to indicate which earpiece it is for. Be sure to attach the left StayHear™ tip to the left earpiece and the right StayHear™ tip to the right earpiece.

3. Ease the base of the tip down around the base of the earpiece until the tip feels secured.

StayHear™ tips

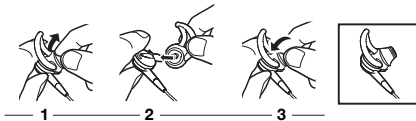

Adjusting for comfort and stability

There are several ways you can adjust your headset to provide additional comfort and stability. Using the adjustment slider and clothing clip you can customize how you wear your headset.

Using the adjustment slider

Move the adjustment slider up or down to reduce or increase the amount of loose cord between the left and right earpiece. Finding the right position for the slider can help optimize the placement of the Answer/End button and integrated microphone.



Using the clothing clip

Use the clothing clip to fasten the cable to your clothing, for convenience, stability, and to help manage the cable. This can be helpful during high-movement activities or when using the headset in a single earpiece configuration.



Using a single earpiece

The Bose® MIE2i mobile headset can be used with only the right (R) earpiece in your ear. This allows you to take calls and still hear surrounding sounds.

Troubleshooting

If you experience any trouble using your headset, try the following troubleshooting instructions. If you still need help, see the contact information on the inside back cover for assistance in your area.

| Problem | What to do |
|--|--|
| No audio/Intermittent | <ul style="list-style-type: none">• Make sure that the headset plug is securely connected to the headphone jack.• Try another audio device. |
| Excessive bass | <ul style="list-style-type: none">• Turn off any audio enhancement features on the audio source. |
| Microphone is not picking-up sound | <ul style="list-style-type: none">• Make sure that the headset plug is securely connected to the headphone jack.• Make sure the microphone is not being blocked or covered <i>The microphone is located on the back of the Answer/End button (you may notice the small opening for the microphone).</i> |
| Phone not responding to button presses | <ul style="list-style-type: none">• Make sure that the headset plug is securely connected to the headphone jack.• For multi-press functions: Vary speed of presses. |
| Apple product not responding to remote | <ul style="list-style-type: none">• Full controls may not be available for some Apple products. |
| Ear tips falling off | <ul style="list-style-type: none">• Make sure the ear tips are securely attached to the earpiece and nozzle hook. |
| Lost ear tip | <ul style="list-style-type: none">• Visit owners.bose.com for replacement tips. |
| Sound is muffled from earpiece | <ul style="list-style-type: none">• Make sure ear tips and headset nozzles are clear of any debris or wax build-up.• Unplug the headset from the audio source, then plug back in making sure they are securely connected.• Try another audio device. |

Cleaning

Your headset may require periodic cleaning:

- **Ear tips:** First, remove them from the headset and wash the tips with a mild detergent and water. Make sure you thoroughly rinse and dry them before putting them back on the headset.
- **Headset nozzles, Microphone, Answer/End, Volume buttons:** Clean only with a dry, soft cotton swab or equivalent. Never insert any cleaning tool into the nozzle or microphone opening.

WARNINGS:

- *Contains small parts which may be a choking hazard. Not suitable for children under age 3.*
- *This product contains magnetic material.*
- *Long-term exposure to loud music may cause hearing damage. It is best to avoid high volume levels when using headphones, especially for extended periods.*
- *Use caution when using your headset/headphones while operating a vehicle or engaging in any activity that requires your full attention. Check and follow local laws regarding mobile phone and headset/headphones use. Some jurisdictions impose specific limitations, such as single earpiece configuration, on the use of such products while driving.*

CAUTIONS:

- *Sounds that you rely on as reminders or warnings may have an unfamiliar character when using headphones. Be aware of how these sounds may vary in character so you can recognize them as needed.*
- *Do not drop, sit on, or allow the headset to be immersed in water.*

Limited Warranty

Your Bose® MIE2i mobile headset is covered by a limited warranty. Details of the limited warranty are provided on the product registration card that is included in the carton. Please refer to the card for instructions on how to register. Failure to register will not affect your limited warranty rights.

What you must do to obtain Limited Warranty service

Return the product, with proof of purchase from an authorized Bose dealer, using the following procedures:

1. Contact the Bose organization in your country/region (visit Global.Bose.com for contact information in your country/region) for specific return and shipping instructions.
2. Label and ship the product, freight prepaid, to the address provided by the Bose organization in your country.
3. Place any necessary Return Authorization Number prominently on the outside of the carton. Cartons not bearing a Return Authorization Number, where required, will be refused.

©2010 Bose Corporation. No part of this work may be reproduced, modified, distributed, or otherwise used without prior written permission.

Apple, iPhone, iPod, iPod classic, iPod nano, iPod shuffle, iPod touch and MacBook are trademarks of Apple Inc., registered in the U.S. and other countries. iPad is a trademark of Apple Inc.

Made for



iPod



iPhone



iPad

"Made for iPod," "Made for iPhone," and "Made for iPad" mean that an electronic accessory has been designed to connect specifically to iPod, iPhone, or iPad, respectively, and has been certified by the developer to meet Apple performance standards. Apple is not responsible for the operation of this device or its compliance with safety and regulatory standards. Please note that the use of this accessory with iPod, iPhone, or iPad may affect wireless performance.

BOSE CORPORATION

USA

The Mountain,
Framingham, MA, 01701
888-757-9943
owners.Bose.com

Canada

9133 Leslie Street,
Suite 120, L4B 4N1
800-905-2177
www.Bose.ca

Australia

Unit 3/2 Holker St. Newington
NSW, 2127
1 800 061 046
www.Bose.com.au

Belgique/Belgie

B-3700 Tongeren
012-390-800
www.Bosebelgium.be

China

2203-2305 22F, West Gate
Tower/1038 West Nanjing
Road-MeiLongzhen Plaza,
Shanghai, 200041
86-400-880-2266
www.Bose.cn

Denmark

2605 Brøndby
4343-7777
www.Bose.dk

Deutschland

D-61381 Friedrichsdorf
06172-71040
www.Bose.de

France

78100 Saint Germain en Laye
01-30-61-67-39
www.Bosefrance.fr

India

Shriram Bhartiya Kala Kendra,
1 Copernicus Marg, New Delhi,
100-001
1-800-11-2673
www.Boseindia.com

Ireland

Castlebury Road,
Carrickmacross, Co
Monaghan
42-967-1500
www.Bose.ie

Italia

Via della Magliana 876
Roma, 00148
800-832-277
www.Bose.it

Japan

Bose K.K.
Shibuya YT Building
28-3 Maruyama-cho
Shibuya-ku, Tokyo 150-0044
TEL: 0570-080-021
FAX: 03-5489-1041
www.Bose.co.jp

Mexico

Paseo de las Palmas # 405,
11000
001-866-693-2673
www.Bose.com.mx

Nederland

1135 GE Edam
0299-390290
www.Bose.nl

New Zealand

0800 501 511
www.Bose.co.nz

Norge

N-2213 Kongsvinger
62-82-15-60
www.Bose.no

Österreich

Wienerbergstrasse 7 (10.OG)
01-60404340
www.Bose.at

Schweiz

Hauptstrasse 134
061-975-7733
www.Bose.ch

Sverige

S-43153 Mölndal
031-878850
www.Bose.se

United Kingdom

1 Ambley Green,
Gillingham Business Park,
Gillingham, Kent, ME8 ONJ
0844-2092630
Info_uk@Bose.com

Hong Kong

Suite 1203, Midas Plaza, 1 Tai
Yau Street, San Po Kong,
Kowloon, Hong Kong
852-2123-9000
support_hk@Bose.com

Finland

Kornetintie 6b Helsinki, 380
010-778-6900
www.Bose.fi

Poland

ul. Woloska 12
Warszawa, 02-675
+48 (0)22-8522928
www.Bose.pl

World Wide Web

www.Bose.com
www.Boseeurope.com

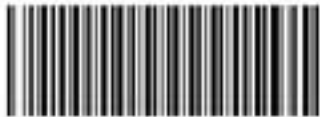

329190-0010

Made for



iPod



iPhone



iPad

BOSE[®]
Better sound through research[®]

©201F Bose Corporation, The Mountain,
Framingham, MA 01701-9168 USA
AM329190 Rev.0H